

**MONUMENT RECORD**  
State of Indiana - County of Monroe

Section: 17

Township: 8 North

Range: 1 East

Corner ID: Sa Cr G-11

**Monument Description & Remarks:** Found Sandstone, tapered from 1.42' base to a point, at Center ¼ of section. "Smith Quillman LS 0427" capped 5/8" rebar found to the NW (see point "B" below).

**References on file in the County Surveyor's Office:** Legal Survey Book No. 2, Page 237; Survey by Lee Utt, R.L.S. No. S-0089, dated March 3, 1975.

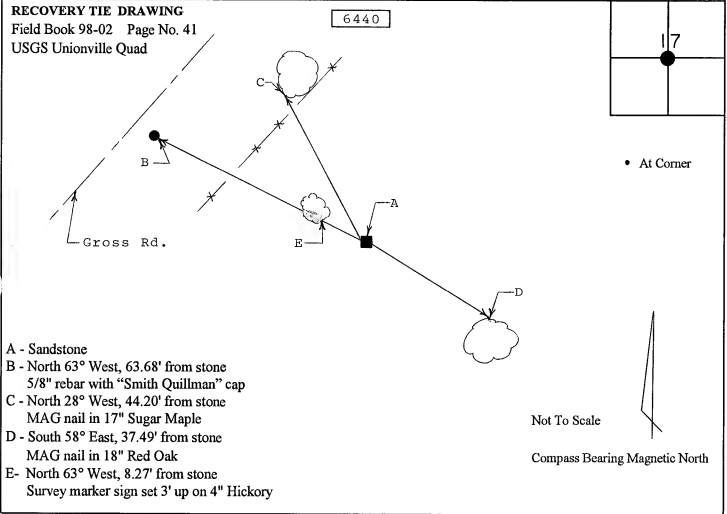

I, Kevin P. Enright, Monroe County Surveyor, hereby certify that this document was prepared under my direction in accordance with the provisions of Section 36-2-2-11 of the Indiana Code; and the above data is given under my hand and seal this 23rd day of November, 1998.

  
\_\_\_\_\_  
SEAL  
MONROE COUNTY INDIANA  
SURVEYOR

Administered by Surveyor Review Board

